

# SABRE MACHINE TOOL INC.



# ABOUT US

- Sabre Machine Tool was established in 1997 with the goal of providing quality products that exceed the expectations of both the industry and the consumer.
- Sabre Machine Tool offers over 20 years of experience in the die, mold, and fixture manufacturing industry. The fulfillment of our goals lies in the strong ambition to provide not just quality products, but customer service unsurpassed by our competitors.
- We have established a comprehensive quality system, which will enable our company to meet all of the requirements of the ISO 9001:2015 quality standard. Through internal procedures, clear work directives and standardized practices, Sabre Machine Tool will strive to contribute to the tooling industry a product, which is defect-free, soundly constructed, and cost competitive.
- With aspirations to emerge as a leading supplier in the die, mold and fixture manufacturing industry, the communication links that are established between the staff at Sabre Machine Tool and our clientele will generate a powerful partnership. It is this partnership, which enables us to develop and maintain a line of goods worthy of our customer's patronage.
- It is our uncompromising commitment to maintain the integrity of our clientele, staff, and the industry, which we endorse and to continually search for ways to improve productivity, reduce prices and shorten delivery times.
- JCP #0046922.
- DUNS #259054963.



# WHAT WE DO

- Die Design
- Processing
- Simulation (FLD, thinning, spring back, etc...)
- New Die Builds
- Die Repairs
- Die Refurbishing
- Eng. Changes
- CMM (Part Layouts, Reporting, verification, reverse engineering, etc...)
- 2D/3D Machining
- Wire Cut
- Fabrication
- Automation



# FACILITY









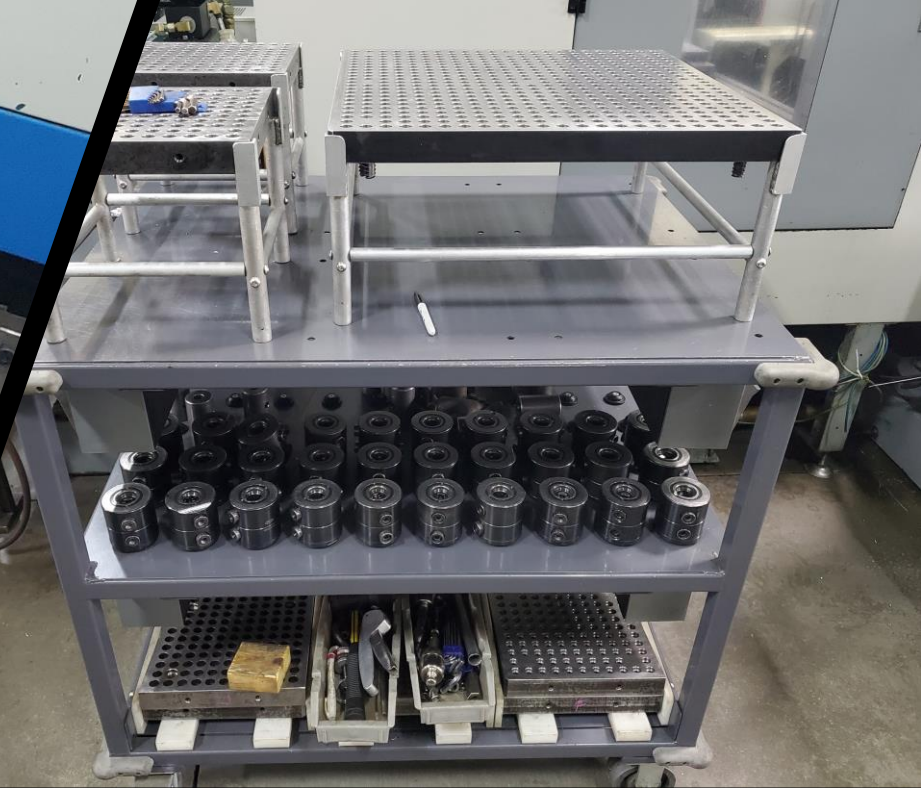
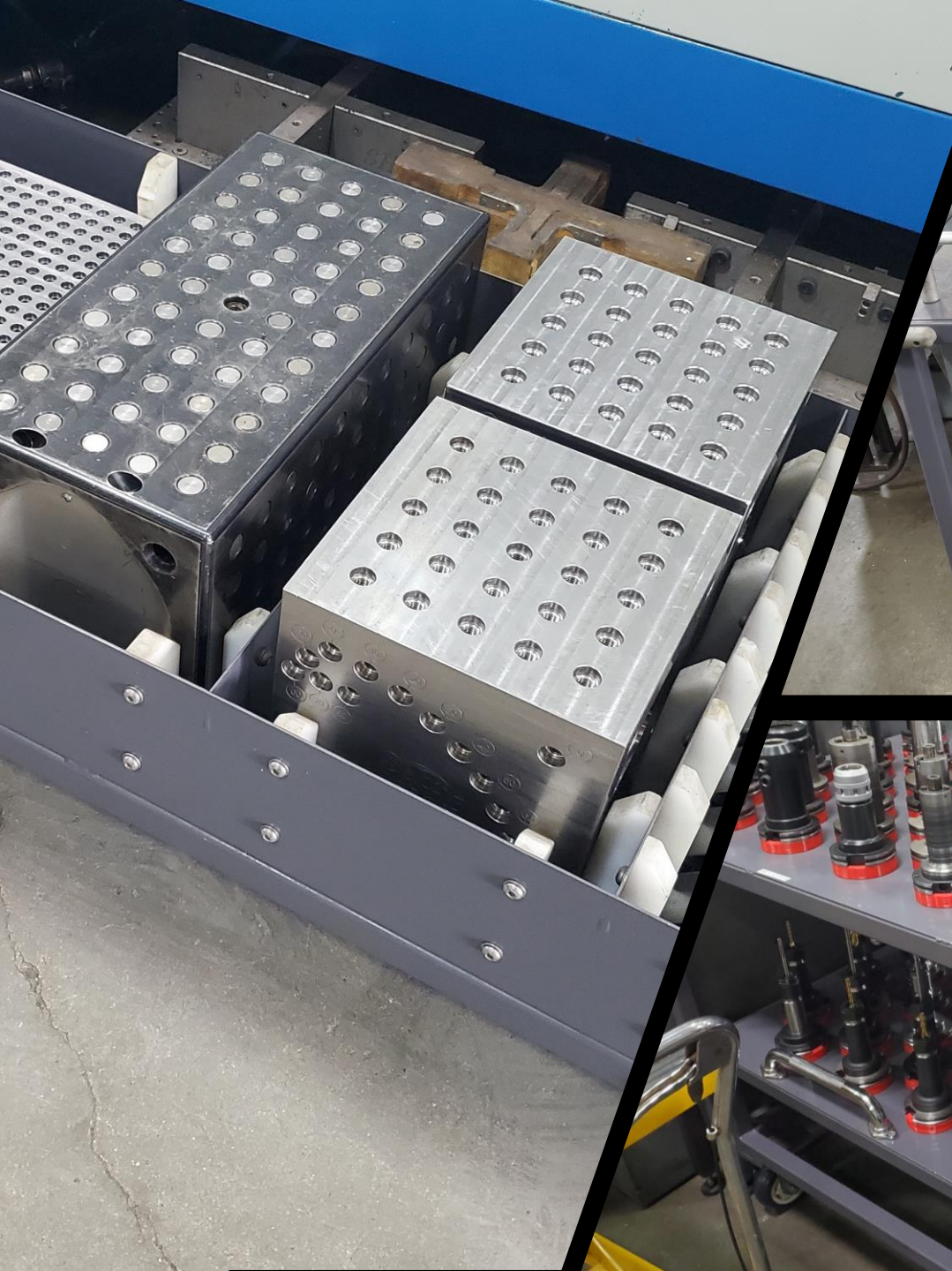

# SOFTWARE

- Cimatron: Complete 2D & 3D Cad/Cam Solutions.
- Dynaform: Complete tooling simulation analysis.
- MasterCam: Machining (2D/3D), and Wire cutting.
- PC-DMIS: Latest technology for CMM.



# CAD/CAM SOFTWARE

Cimatron is our integrated 3D design & cam software that is used from beginning to end. From Part data -> strip layout -> full design -> cnc machining. By using the same software, this streamlines our complete process.

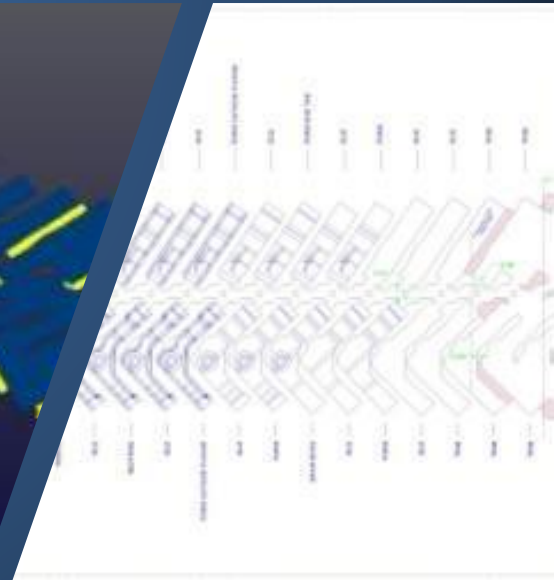
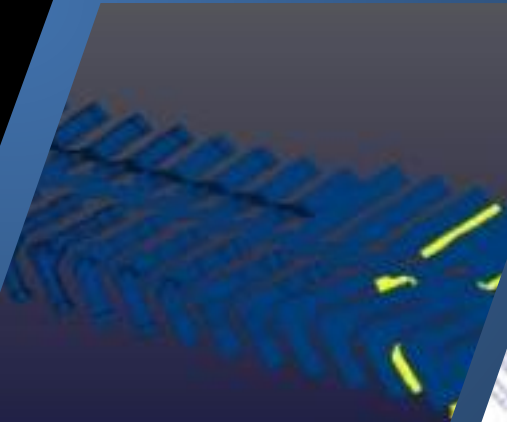
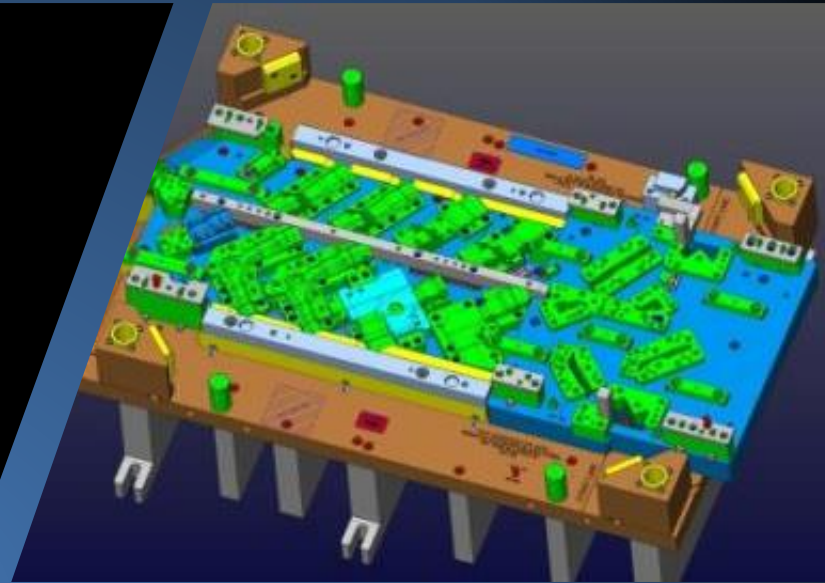



# SIMULATION SOFTWARE

Dynaform is LS-DYNA based simulation solution. It allows us to prove a forming process even before starting the design.

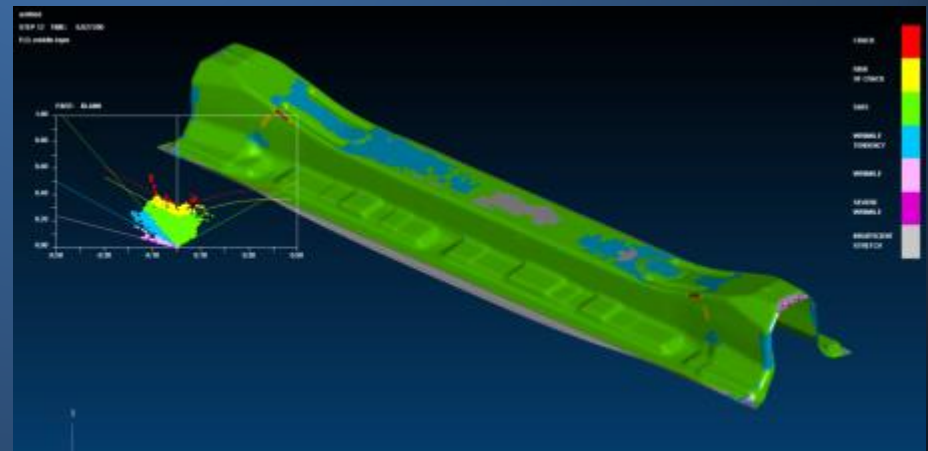
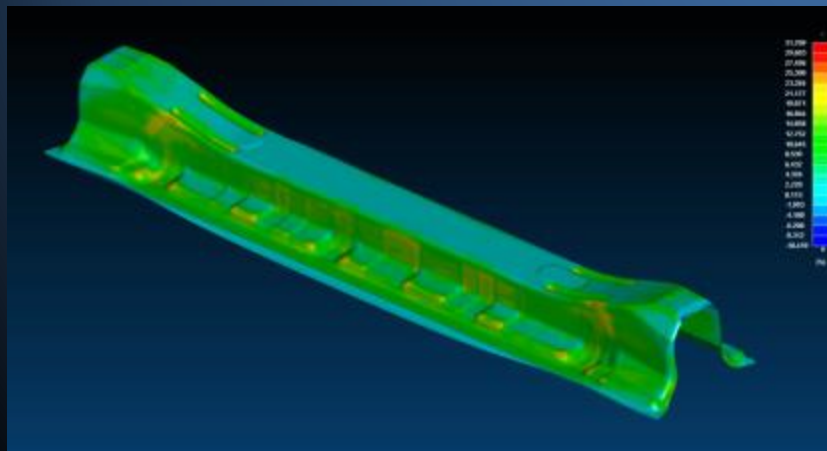
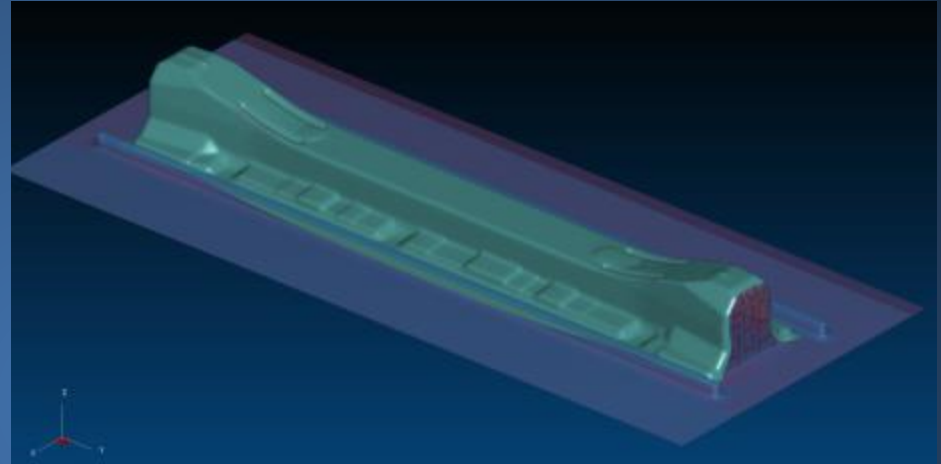

# CMM SOFTWARE

PC-DMIS is a measurement software solution for metrology professionals.



Brown & Sharpe Xcel 9-15-9  
(X-59" Y-35.4" Z-33.5")



# EQUIPMENT

## CNC Machines:

Takumi H32T - X126" Y88" Z34"

AWEA SP3016 - X120" Y63" Z34"

Takumi V22A - X86" Y42" Z29"

Awea BM-1600 - X63" Y32" Z31"

Quasar MV184 - X40" Y20" Z24"

## CMM Machine:

Brown and Sharpe Xcel 9-15-9 X59" Y35" Z28"

## Wire cut:

Charmilles Robofil 510 Wire-cut EDM

## Stamping Press:

Danly 4PT 400 ton press, Bolster: 113.5" x 72", Shut height: 26.75" - 38", Windows: 42"

## Print board:

Paperless shop floor with the most up to date designs/prints

## Misc:

Band saws, Knee mills, Milling machines, Radial drills, Surface grinders, etc...



# Cnc & Wire Machines



# Programming Stations



# PRINTBOARD



Paperless shop floor with the most up to date designs/prints



# 400 TON DANLY 4PT PRESS

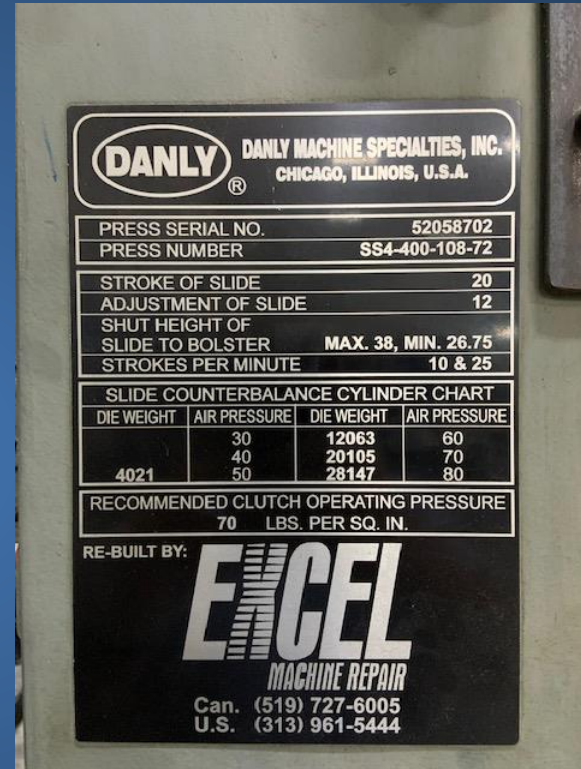

DANLY DANLY MACHINE SPECIALTIES, INC. CHICAGO, ILLINOIS, U.S.A.			
PRESS SERIAL NO.		52058702	
PRESS NUMBER		SS4-400-108-72	
STROKE OF SLIDE		20	
ADJUSTMENT OF SLIDE		12	
SHUT HEIGHT OF SLIDE TO BOLSTER		MAX. 38, MIN. 26.75	
STROKES PER MINUTE		10 & 25	
SLIDE COUNTERBALANCE CYLINDER CHART			
DIE WEIGHT	AIR PRESSURE	DIE WEIGHT	AIR PRESSURE
	30	12063	60
	40	20105	70
4021	50	28147	80
RECOMMENDED CLUTCH OPERATING PRESSURE 70 LBS. PER SQ. IN.			
RE-BUILT BY:			
<b>EXCEL</b>			
MACHINE REPAIR			
Can. (519) 727-6005			
U.S. (313) 961-5444			

Bolster: 113.5" x 72"

Shut Height: 26.75" - 38"

Stroke: 20"

Windows: 42"

Note: If required we have access to presses  
that range from 600- 1000 Ton

# Past Material Type Examples

Mild/Hot Rolled: CS/CQ, DQ, DDQ, JAC/JSC270, SP121/781

Galvanneal/Galvanized

High: HSLA250 to 550, SPH440, SCGA440-45,

Advanced High: DP590, DP780, JAC590, SP151-590

Aluminum: A3004P-0, WSS-M2A175-A2

And more...

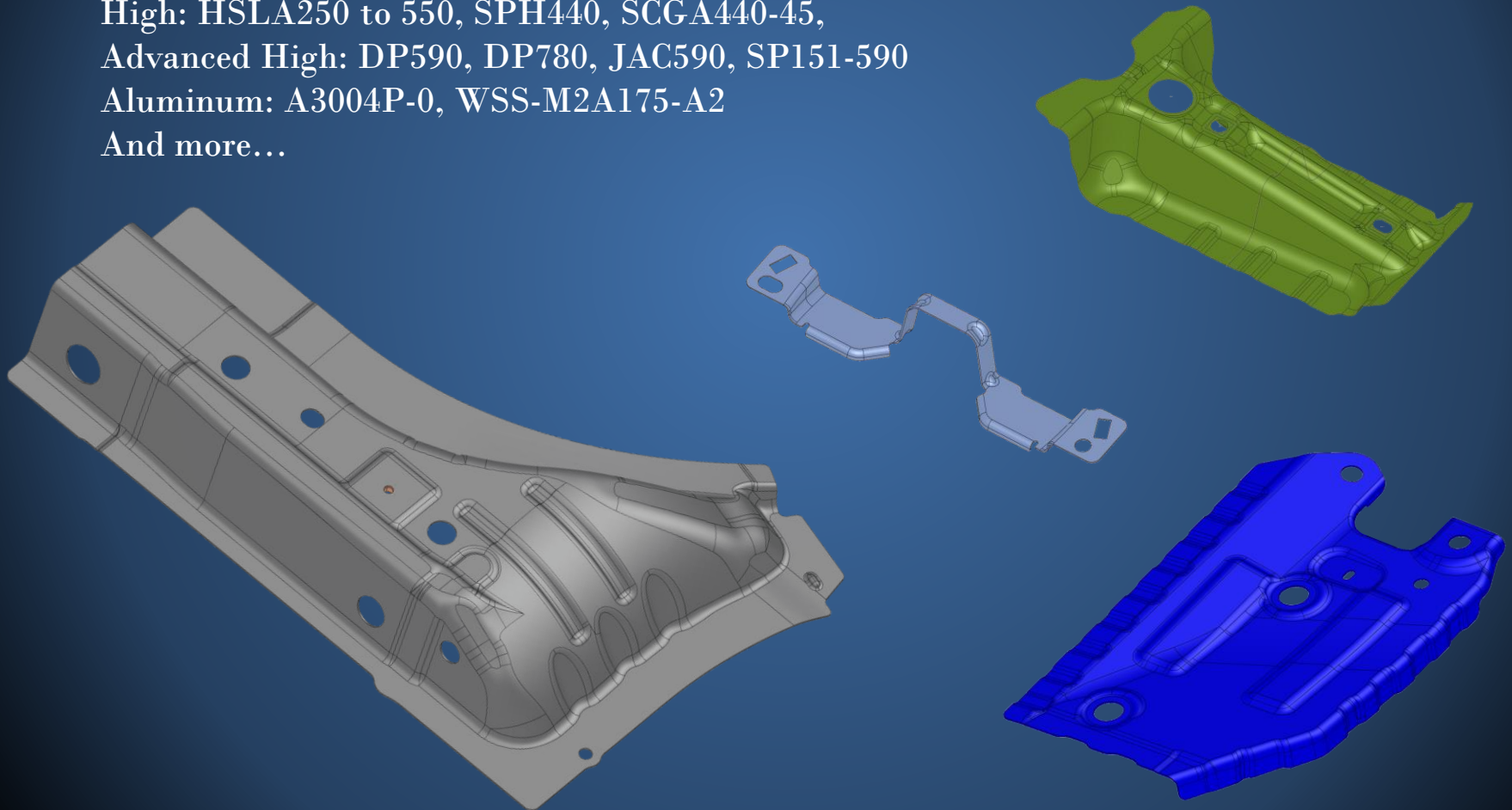



# Prog - Transfer - Tandem

We Build all types of tooling, cast or plate construction.

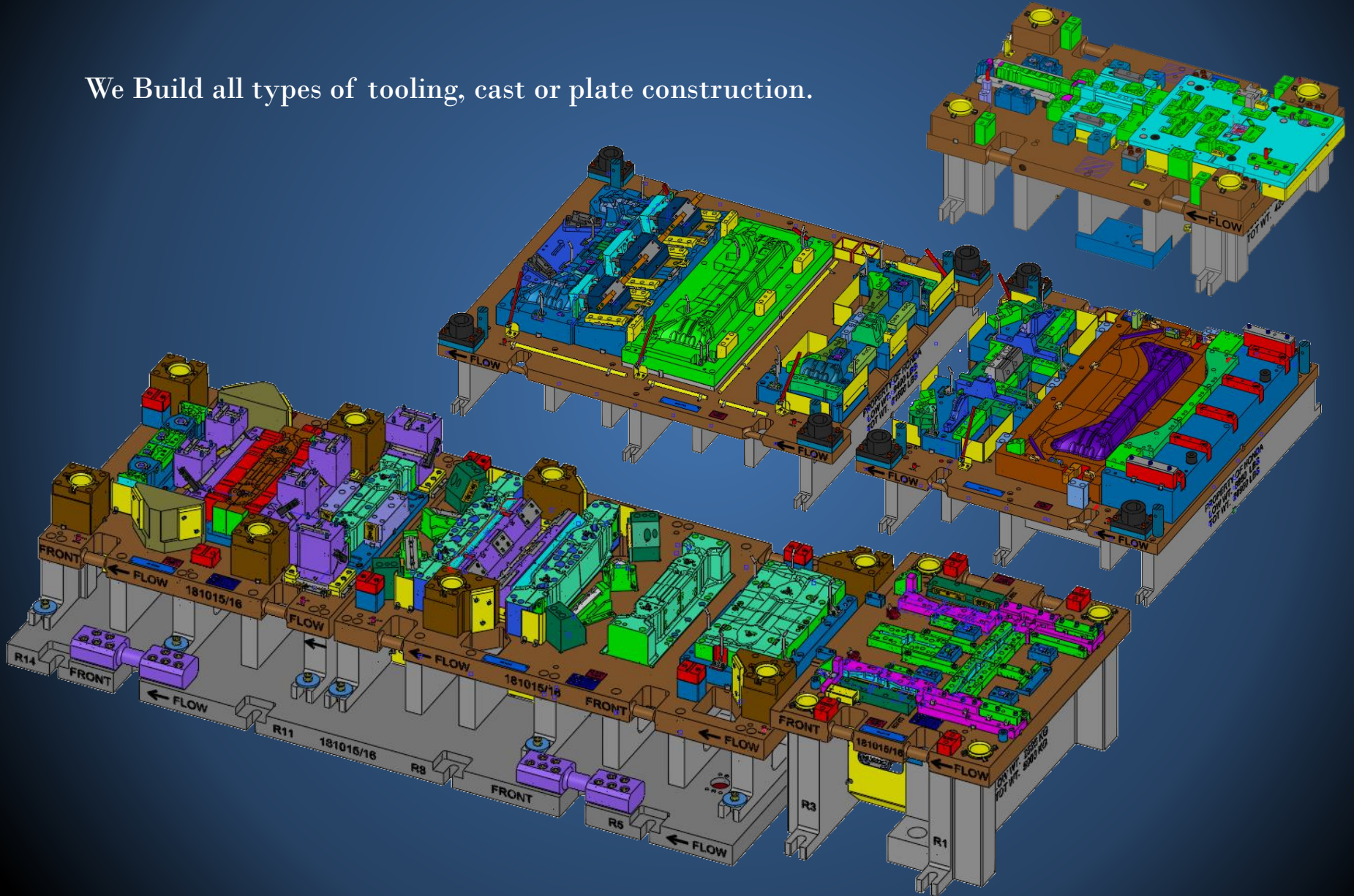



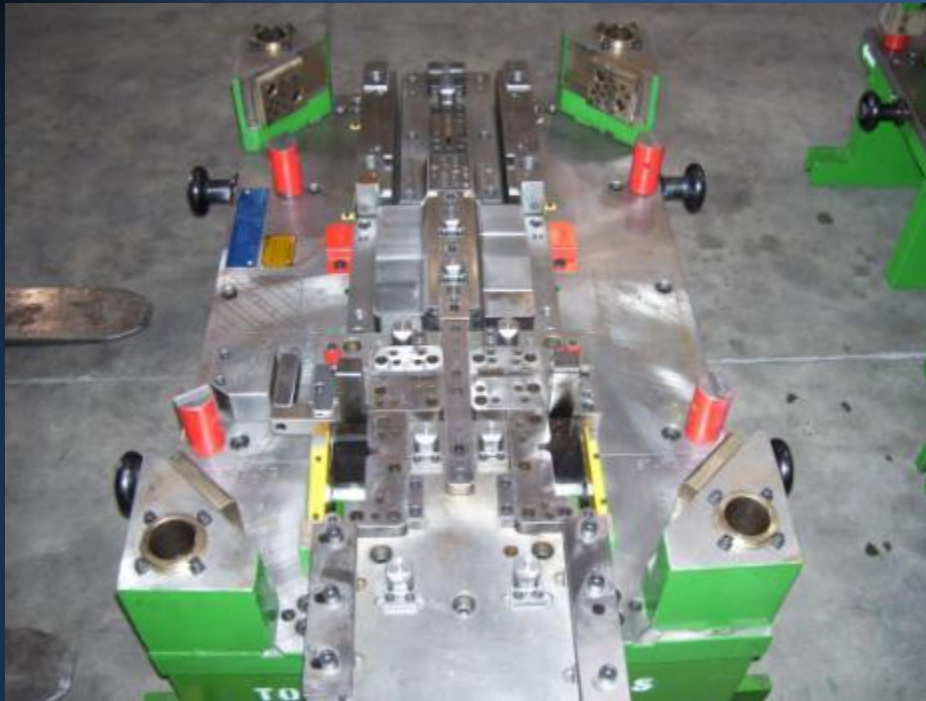

We pride ourselves in taking the extra measures necessary to ensure that our customers are satisfied with the level of craftsmanship and service received from our sales, administration, engineering, and operations departments.



# THANK YOU!!!

From all of us we want to thank you for considering  
Sabre Machine Tool Inc.

